

CHILDREN'S ELECTRONIC TOY CAR OPERATION INSTRUCTIONS

Please read this manual in detail before using

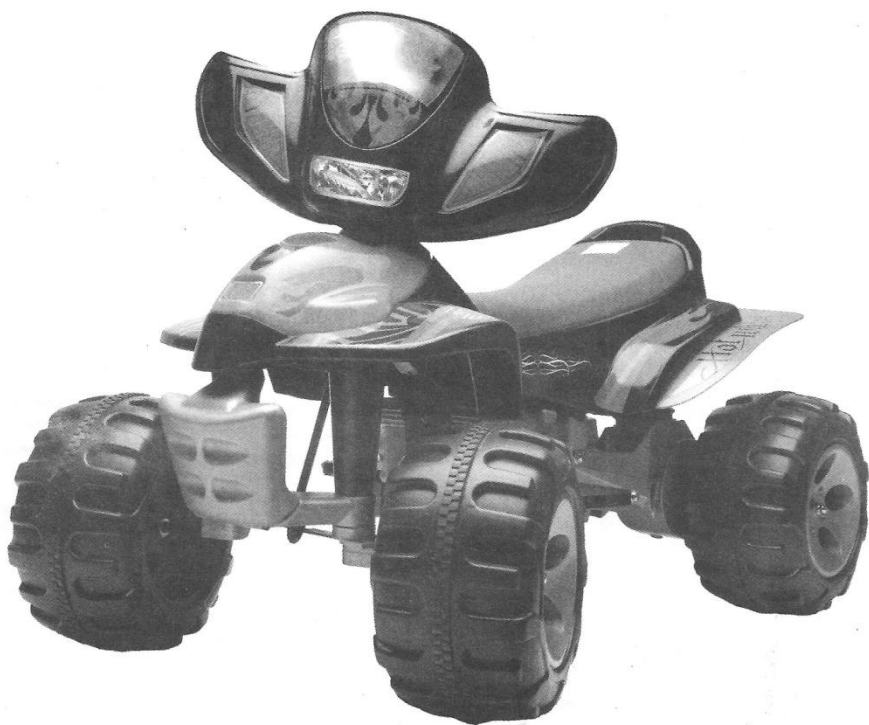

- Suitable for age 3+ years.
- Always wear helmet when riding.
- Your new vehicle requires adult assembly.
- Charging the battery can only be operated by adult all times.
- This toy is equipped with a safety isolating transformer. Cable, cord an plug should be examined before using.
- Please keep this manual for future reference as it contains.

Have already implemented ISO9001:2000 authentication

Table of contents

1. About Our Product	-----
2. The Specification	-----
3. Parts	-----
4. Cautions For Safety	-----
5. Parts Diagram	-----
6. Assembly Steps	-----
7. How To Operation The Vehicle	-----
8. Fuse	-----
9. Charging The Vehicle	-----
10. Maintaining Your Vehicle	-----
11. Trouble Shooting Guide	-----
12. Disposal Of Battery	-----

1. About Our Product:

Thank you for your purchasing our products, we always keep pursuing being outstanding and designing comfortable and safe ride-on car for children .it will provide your children a wonderful childhood and your family lots of happiness.

Please read the manuals carefully before using this product. You can get correct operation method, simple and detailed installation procedure. Moreover, it can instruct you how to prevent improper way of operation, because any incident can result in serious injury.

Please read it carefully to make sure that all children obey all warning, cautions, instructs and safety topics and assure young riders are able to safely use this product.

2. The Specification

Suitable age:	3+ years	Battery:	DC6V10AHX2
Capacity:	40kgs	Size of car:	102x65.5x102cm
Speed:	2.5-5km/HR	Charging times:	About 300 times
Charger input:	Deopd on local voltage	Output:	DC 12V
Power way:	Charing type	Fuse:	F 18A and 7A

3.Parts list

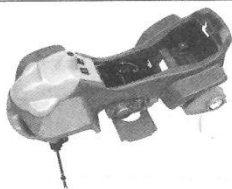

1.Vehicle Body x1



2.Face Guard x1

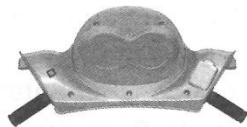

3.Handlebar Assembly x1



4.Seat x1



5.Font-wheels x2



6.Rear wheels x2



7.Wheel Covers x4



8.Mudguardsx1 set



9.Steering Shaft x1



10.Rear Axle x1

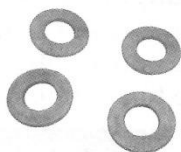

11.Ø12Washersx12



12.Split pins x2



13.M4x16 Screws x14



14.Spanner x1

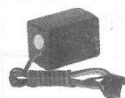

15.Charger x1

4. Cautions for safety

1. While riding, adult supervision is required at all times.
2. Always wear a helmet when riding.
3. Do not drive near roads or on the footpath.
5. It is not recommended to ride this vehicle on sandy or soft surfaces.
4. It is not recommended to drive the vehicle on wet surfaces or on lopes of greater than 15 degrees.
6. Do not use this vehicle outdoors when it is raining.
7. Make sure you come to a complete stop before changing directions from forward to back.
8. Don't allow children to operate the charger or play with the battery.
9. Clean the vehicle with a dry cloth only.
10. Please follow the correct weight and age limits allowed to drive this vehicle.
11. It is prohibited to change the circuit or add other electric parts.
12. Adults must teach their children about safe driving procedures.
13. Please cut off the power when stop diving.
14. Check the seat. Whether it has been fitted and secured with a bolt before driving.
15. Inspect wires and connections of the vehicle periodically.
16. Charging the battery should only be done by adults.
17. Charging plug is located underneath the seat.
Check all wire plugs and connections periodically.
18. In order to avoid accidents, please ensure the vehicle is safe before riding.
19. Do not let any child touch the wheels or be near them when the car is moving.

5. Parts Diagram

Note : some parts shown are assembled on both sides of vehicle.

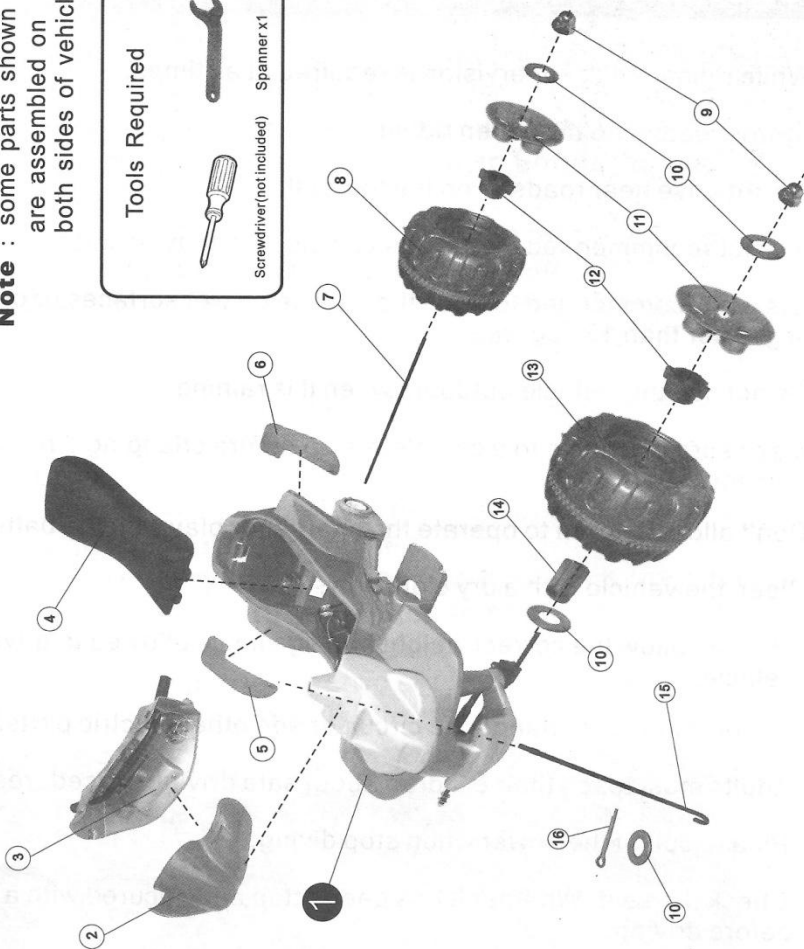
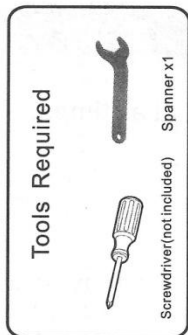

①	Vehicle bodyX1
②	Face Guard x1
③	Handlebar Assembly x1
④	Seat x1
⑤	L Mudguard x1
⑥	R Mudguard x1
⑦	Rear Axle x1
⑧	Rear wheel x2
⑨	Locknut x4
⑩	∅ 12 Washer x12
⑪	Wheel Cover x4
⑫	Bush x4
⑬	Font-wheel x2
⑭	Axle Sleeve x2
⑮	Steering Shaft x1
⑯	Split pins x3

6. Assembly Steps

- Your new vehicle requires adult assembly. Please set aside at least 40 minutes for assembly. Children can be harmed by small parts, sharp edges and sharp points in the vehicle's unassembled state. Care should be taken in unpacking and assembly of the vehicle. Children should not handle parts, or help in assembly of the vehicle.
- Please identify all parts before assembly and save all packaging material until assembly is complete to ensure that no parts are discarded.
- Assembly tool for need: screwdriver (provide for oneself) and spanner.

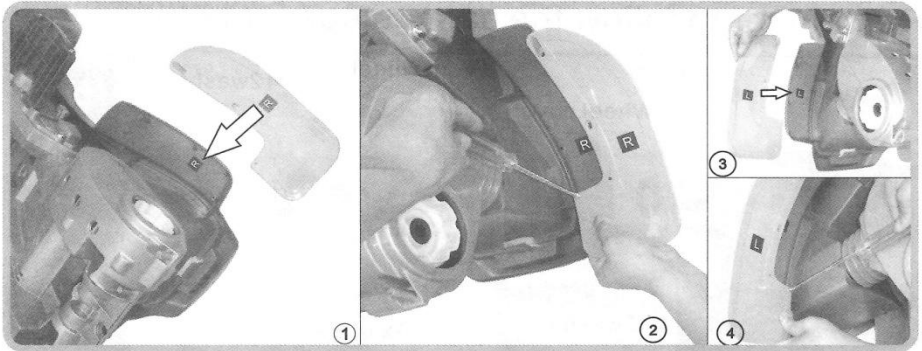

1 ASSEMBLE MUDGUARDS

Note: The mudguards and the vehicle body are marked "R" and "L" to designate right and left.

Turn the vehicle around. With the "R" marking facing up, click in the "R" mudguards into position and use four 4X16 screws to secure it onto the vehicle body.

Repeat the assembly steps to assemble the left ("L") mudguards to the vehicle body.

6. Assembly Steps

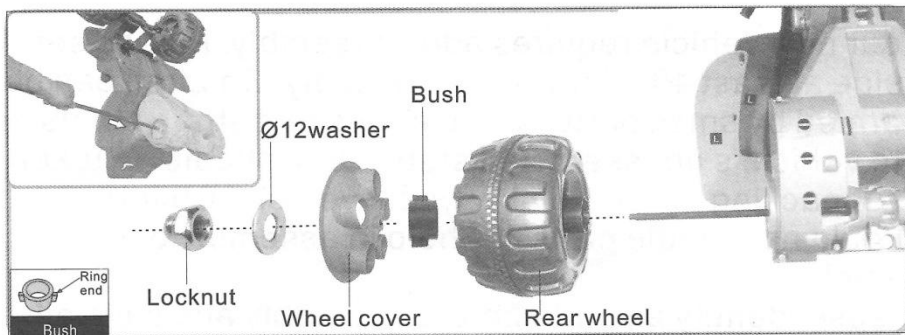

2. ASSEMBLE REAR WHEEL

Click on the rear axle into the position.
Follow the steps of rear wheel, bush (ring end last), wheel cover, Ø12washer and Locknut (see image) through the rear axle to secure.

Remember to follow the same steps for both sides.

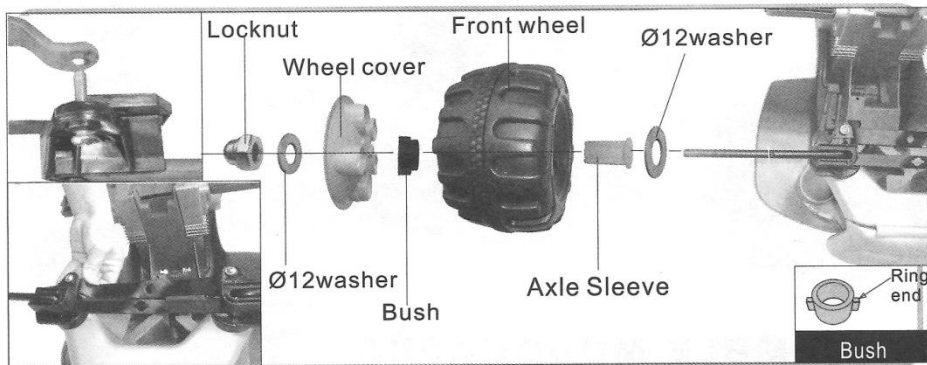

3. ASSEMBLE FRONT WHEELS

Undo the nut on the gimbal, then assemble the steering arm and tighten the nut.
Follow the steps of Ø12washer, axle sleeve, front wheel, bush (ring end last), wheel cover, Ø12washer and locknut (see image) through the rear axle to secure.

Remember to follow the same steps for both sides.

6. Assembly Steps

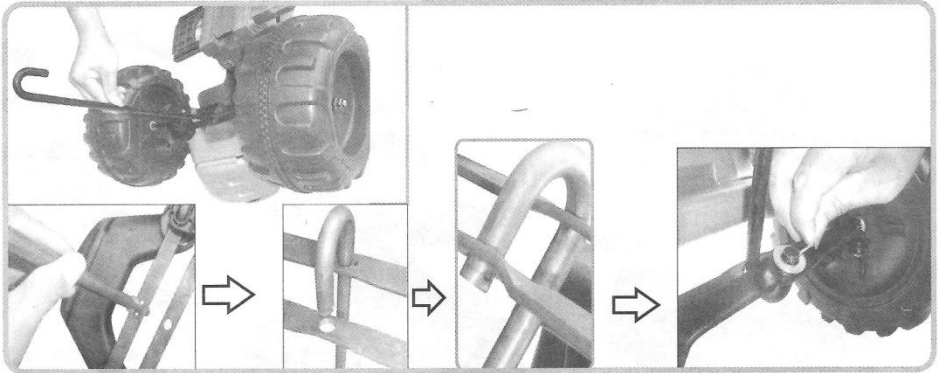

4. ASSEMBLE STEERING SHAFT

From underneath the vehicle body, follow the steps insert the steering shaft through the plate (see image). Remember to use $\varnothing 12$ washers and split pins to secure the steering shaft.

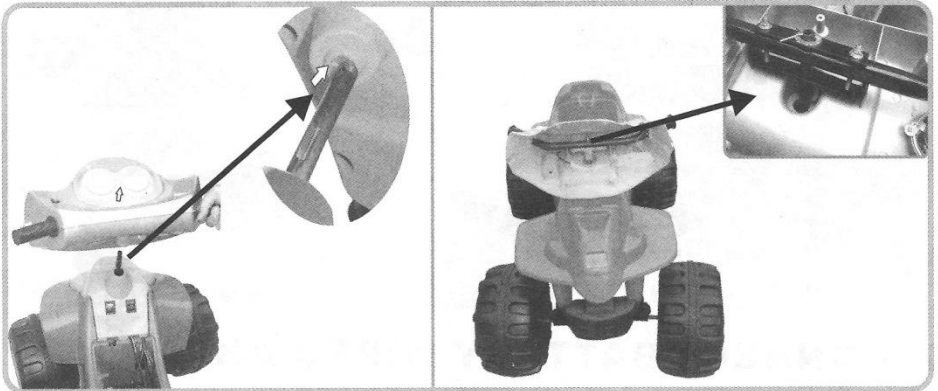

5. ASSEMBLE HANDLEBAR ASSEMBLY

Insert the steering shaft in the handlebar assembly, and then fix with the $\varnothing 12$ washer and split pin.

6. Assembly Steps

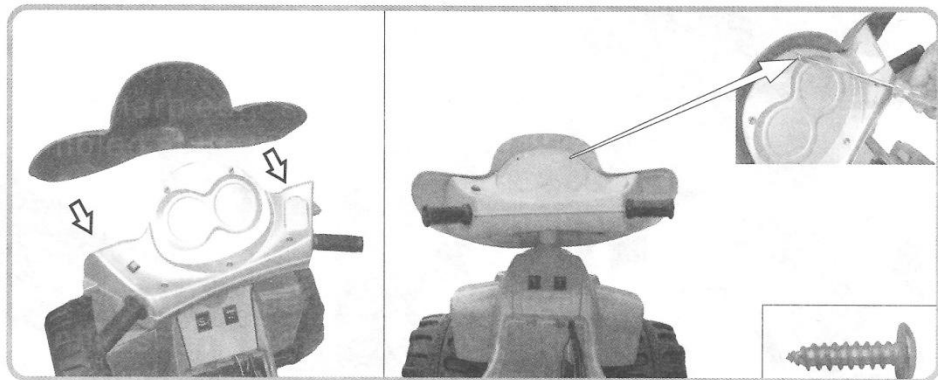

6. ASSEMBLE FACE GUARD

Fit the face guard to the handlebar assembly. Insert six M4x16 screws through the handlebar assembly, tighten the screws with a phillips screwdriver.

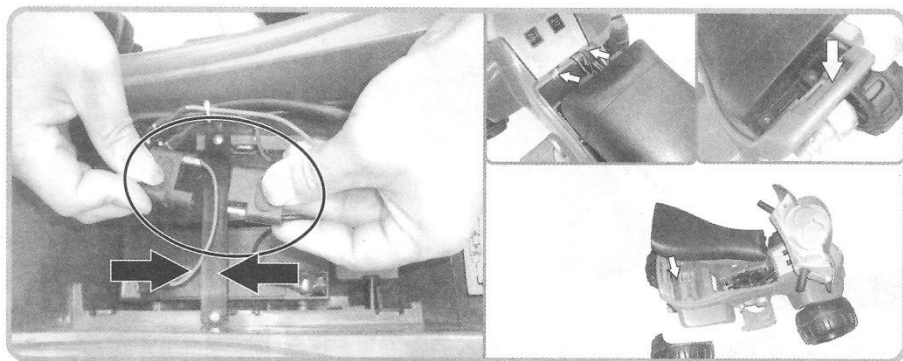

7. CONNECT BATTERY WIRES AND ASSEMBLE THE SEAT

Remove the plastic protector from the battery connector. Connect the connector as picture. Fit the seat over the vehicle body .

7. How To Operate The Vehicle

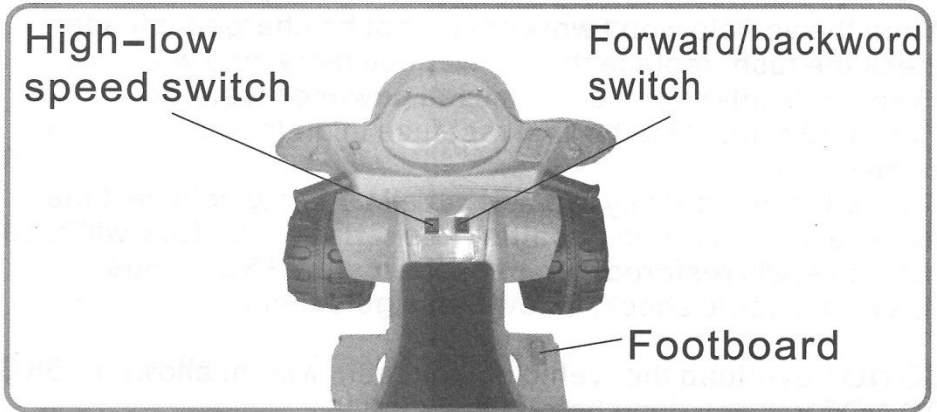

FORWARD

1. Press the direction switch on the forward position.
2. Select "Slow" or "fast".
3. Step on the Footboard.

STOP

The vehicle stop moving when unclasp the footboard.

BACKWARD

1. Press the forward/backward switch on the backward position.
2. Select "Slow" or "fast".
3. Step on the Footboard.

Turn off the vehicle

Press the forward/backward switch into the middle position.

NOTICE:

- Have to instruction child, should unclamp the foot board first while changing the speed or direction ,wait for the vehicle to come down statically and can go on .
- Forbade suddenly varying forward and back in the course of going, otherwise went back to decrease the lines and transmission parts of the ring vehicle, or cause other unexpected emergence!

8. Fuse

When the vehicle won't work or can not be charged, please check the fuse .replace the fuse if necessary, and wait for 15 seconds after the fuse reset and power or restored.

The car features two thermal rest fuse in under the seat Refer to the picture.

They will automatically trip and cut all power to vehicle if the motor, electric system or battery is overload. The fuse will reset and powerwill restored, after approximately 15 seconds.

to avoid electric shock, follow these guidelines:

DO NOT overload the ,vehicle ,Maximum weight allowed:35KG.

DO NOT tow any thing behind the vehicle.

DO NOT drive up steep slopes.

DO NOT drive in fixed objects. which may cause the wheels to spin, causing the motor to overheat.

DO NOT drive in very hot weather , components may overheat.

DO NOT allow water or other liquids to come in contact with the battery or other electric components.

DO NOT tamper with the electric system. Doing so may create a short circuit, causing the fuse to trip.

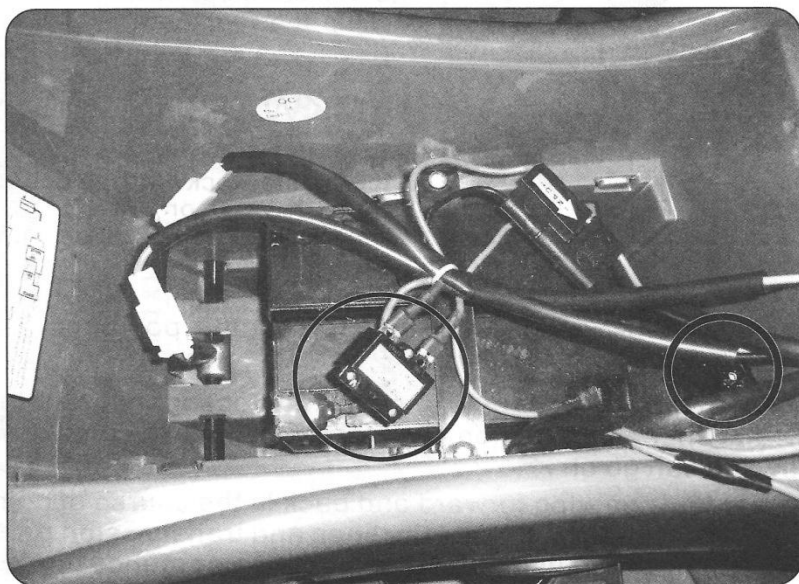

9. Charging The Vehicle

The charging input plug is under the seat. Connect charger plug to battery input plug to charge the battery.

Charging the battery should only be done by an adult.

Caution: You must charge the 6-Volt battery for a "Full" 10 hours prior to use.

Never charge the battery longer than 16 hours.

Failure to charge the battery as directed will cause permanent damage to the battery.

After each use, or once a month minimum, recharge the battery of your vehicle for 8-10 hours. Do not charge the battery longer than 16 hours.

NEVER run battery completely flat.

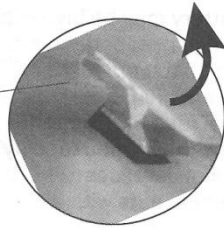
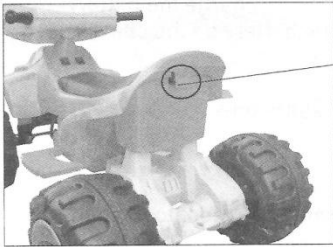

Press the tab under the back of the seat and remove the seat .

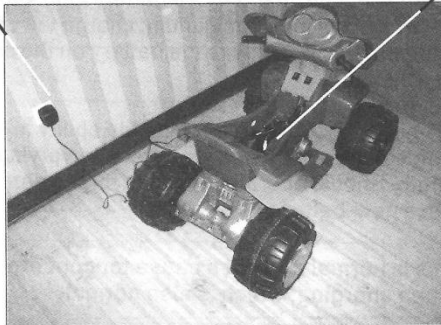
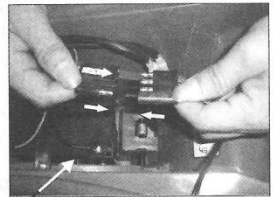
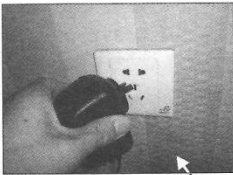

10. Trouble Shooting Guide

Problem	Possible Cause
(1). The battery Will not recharge	<ol style="list-style-type: none"> 1. Motor connector or adapter connector is loose. Make sure the motor connector and the adapter connector is firmly plugged. 2. The battery will not recharge. Make sure the charger is plugged into a 240v wall outlet and the power flow to the outlet is on. 3. Charger is not plugged in. Make sure the charger is plugged into a 240v wall outlet and the power flow to the outlet is on. 4. Check and replace fuse if necessary
(2). The vehicle does not run	<ol style="list-style-type: none"> 1. The battery may be low on power. After each use, or once a month minimum, charge the battery for a "full" 10 hours. DO NOT leave the battery on the charger for more than 16 hours. 2. Thermal fuse has tripped. Replace the tripped fuse by another spare one. 3. Wheel nuts are loose. If the wheel nuts with a wrench. 4. Motor connector or wires are loose. Make sure the motor connector is firmly plugged into the battery. 5. Battery is dead. Have you properly maintained the battery according to the directions? Is the battery old? Your battery may need to be replaced. 6. Electrical system is damaged. Water may have corroded the system, or loose dirt, gravel or sand might have jammed the switch. Check. 7. Motor is damaged. The vehicle needs professional repair.
(3). The vehicle does not run very long.	<ol style="list-style-type: none"> 1. Battery may be undercharged. You may not be charging the battery long enough. After each use, or once a month minimum, charge the battery for a "full" 10 hours. DO NOT leave the battery on the charger for more than 16 hours. 2. Battery is old. The battery will eventually lose the ability to hold a charge. Depending on the amount of use, and varying conditions, the battery should operate for one to three years. Replace the battery with a new battery.
(4). Battery buzzes or gurgles when charging.	<ol style="list-style-type: none"> 1. This is normal and not a cause for concern. It may also be silent When charging, which is also normal.

10. Trouble Shooting Guide

<p>(5).Charger feels warm when recharging battery.</p>	<p>1.This is normal and not a cause for concern.</p>
<p>(6).The vehicle runs sluggishly or beeping occurs.</p>	<p>1.Battery needs recharging. After each use, or once a month minimum, charge the battery for a "full" 10 hours. DO NOT leave the battery on the charger for more than 16 hours. Low battery signal will sound when the battery is running low on power.</p> <p>2.Battery is old. The battery will eventually lose the ability to hold a charge. Depending on the amount of use, and varying conditions, the battery Should operate for one to three years. Replace the battery with a new battery.</p> <p>3.Vehicle is overloaded. Maximum weight is 35 kg. DO NOT overload the vehicle. DO NOT tow anything behind the vehicle. ONLY one rider at a time.</p>
<p>(7).Difficulty Shifting into forward or reverse</p>	<p>1.Trying to shift while the vehicle is moving. The vehicle MUST come to a complete stop before shifting into reverse and back into low or high speed otherwise damage to the gears and motor WILL occur.</p>
<p>(8).Loud grinding or clicking noises coming from motor or gear box..</p>	<p>1.Gears are stripped or broken. It needs to be replaced.</p>
<p>(9).The vehicle needs a push to go forward.</p>	<p>1.Poor contact of wires or connectors. Make sure the motor connector is firmly plugged into the battery. Check for loose wires around the motor and reconnect if necessary.</p> <p>2."Dead spot" on motor. A "dead spot" means the electric power is not being delivered to the terminal connection.</p>

11. Maintaining Your Vehicle

- Occasionally use a lightweight oil to lubricate moving parts such as wheels and the steering linkages.
- Park the vehicle indoors or cover it with a tarp to protect it from wet weather.
- Keep the vehicle away from sources of heat, such as stoves and heaters. Plastic parts may melt.
- **ADULTS ONLY:** Recharge the battery after each use. Recharge the battery at least once a month when the vehicle is not being used. See pages 10 for instructions about recharging the battery.
- **DO NOT** wash the vehicle with a hose. **DO NOT** wash the vehicle with soap and water.
- **DO NOT** drive the vehicle in rainy or snowy weather. Water will damage the motor, electric system and battery.
- Clean the vehicle with a soft, dry cloth. To restore shine to plastic parts, use a non-wax furniture polish. **DO NOT** use car wax. **DO NOT** use abrasive cleaners.
- **DO NOT** drive the vehicle in loose dirt, sand or fine gravel, which could damage moving parts, motors or the electric system.

12. Disposal Of Battery

Disposal of Battery



- Your sealed lead-acid battery must be recycled or disposed of in an environmentally sound manner.
- Do not dispose of your lead-acid battery in a fire. The battery may explode or leak.
- Do not dispose of a lead-acid battery in your regular, household trash. The incineration, land filling or mixing of sealed lead-acid batteries with household trash is prohibited by law.
- Return an exhausted battery to your local approved lead-acid battery recycle, such as a local seller of automotive batteries.
- Contact your local waste management officials for other information regarding the environmentally sound recycling and disposal of lead-acid batteries.